



JETWAVE

PROFESSIONAL VACUUM CLEANERS

Distributed by:

DAKOTA™ 3FLOW



Heavy Duty Usage

FIELDS OF APPLICATION

- Factories
- Concrete Cleaning
- Construction Sites
- Cleaning Contractors
- Hire and Rental Companies



NEW

The Jetwave® Dakota™ 3Flow is a professional dry vacuum cleaner specific for fine dust that features automatic filter cleaning during operation. Engineered and assembled using only the best quality Italian components.

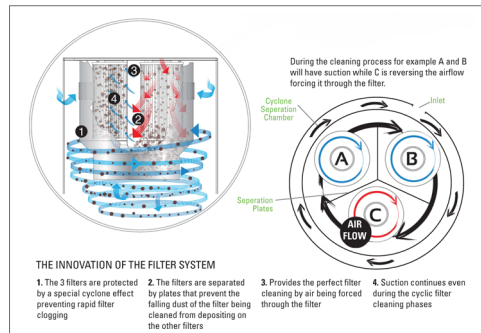

HERO INNOVATIONS

- 3Flow Technology**
Filter cleans automatically and cyclically with 2 suction motors and 1 motor idling.
- Black is Green**
75% recycled eco-friendly plastic.
- Innovative Gasket**
Exclusive fusion casted in base seal to provide maximum resistance and durability.
- Chrome Steel Tube(s)**
Strong chrome steel poles for robust performance.

STANDOUT FEATURES

- 3 x double stage motors with by-pass cooling and high air flow.
- Works continuously with two suction motors and one motor idling.
- Oversized offset CYCLONE™ side inlet to prolong filter blockage.
- Ultra shock proof plastic side handles with holding tank.
- UV and shock resistant plastic head.
- Inner barrel sleeve for easier cyclonic movement and delay filter clogging.
- Reliable construction for intensive use.
- Practical cable hook and clip on pole storage.
- Ergonomic top handle.
- 3 x Cartridge filters included for added filtration and protection from fine dust.
- PowerHook™ 2-stage strong flexible nylon care cleat for easy removal of top head.
- Heavy duty rubber wheels for easy mobility.
- Bend-flex crush proof hose to withstand stress and distortion.
- Independent motors with ON/OFF illuminated switch.



Jetwave Group
 72-74 Richmond Road
 Keswick | Adelaide
 South Australia | 5035 | AU
 +61 8 8371 3599
 sales@jetwave.com.au
 jetwave.com.au



Product Code	p/n	10317
--------------	-----	-------

INTENDED APPLICATION

Usage		Dry
-------	--	-----

TECHNICAL DATA

Motor	watts	3000
Motor	no. / stage	3 / 2
Power	voltage	250
Cable Length	metres	8.5
Airflow	m3/h	476
Waterlift	mmH ² O	2560
Tank Capacity	litres	62
Filtering Surface	cm ²	6500
Material	type	Plastic
Diameter of Accessories	mm	38
Standard Hose Length	metres	4
Optional Tooling Available	y / n	Y
Sound Pressure Level	dB(A)	74

DIMENSIONS & WEIGHT

Approx Weight	kg	25 unit / 32 boxed
Unit Dimensions	mm	680(L) x 550(W) x 900(H)
Boxed Dimensions	mm	700(L) x 600(W) x 950(H)
Number per Pallet	type: pieces	AS: 4 / Euro: 2

WARRANTY(S)

Warranty	years	1	
----------	-------	---	---

*Coverage against defects in material and workmanship (refer to Jetwave's and component partners T&Cs).